



Member FDIC

# CARD CONTROL QUICK GUIDE SETUP

Our Card Control app gives you the power to monitor and manage your Bank Forward debit cards. With Card Control, you have peace of mind knowing you can:

- Get real-time notifications when your card is used
- Easily lock and unlock your card when needed
- Restrict transactions
- Set security preferences and spending limits

Follow these easy steps to start using Card Control:

1 Login to your Bank Forward mobile app on your mobile device.

Chose **CARD CONTROL** from the *Menu*.

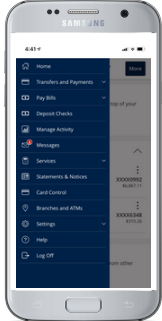

You will receive a warning that you are being redirected to the AppStore, select **YES** to continue and you will be taken to the Card Control app in your respective app store.

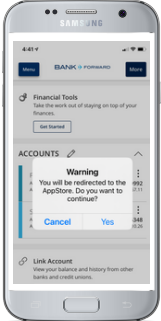

2

3

Select the **GET/INSTALL** button to begin downloading Card Control on your mobile device.

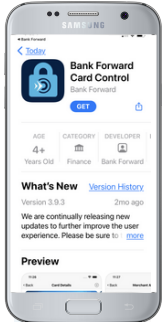

**DO NOT OPEN THE CARD CONTROL APP AFTER INSTALLING.** You must go back to your Bank Forward mobile app to sync the two apps and complete the setup.

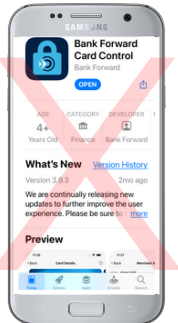

4

5

6

Open the Bank Forward mobile app.

7

Chose **CARD CONTROL** from the Menu and follow the steps to complete setup.

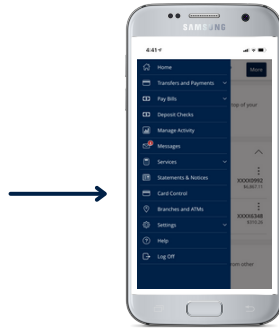

8

Add your Bank Forward debit cards and start using Card Control.



a

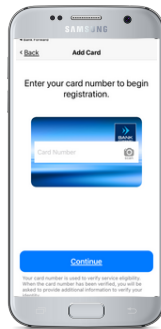

b

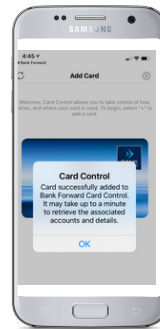

c

Note: Once the initial enrollment is complete, you can access Card Control from the Bank Forward mobile app or the Card Control app using the same login and password.

Learn more at [www.BankForward.com/CardControl](http://www.BankForward.com/CardControl)